

UM3A-2212-EU-PIR Movement Monitor

Part of the Silent Alert SA3000 Paging System for deaf & deaf-blind People

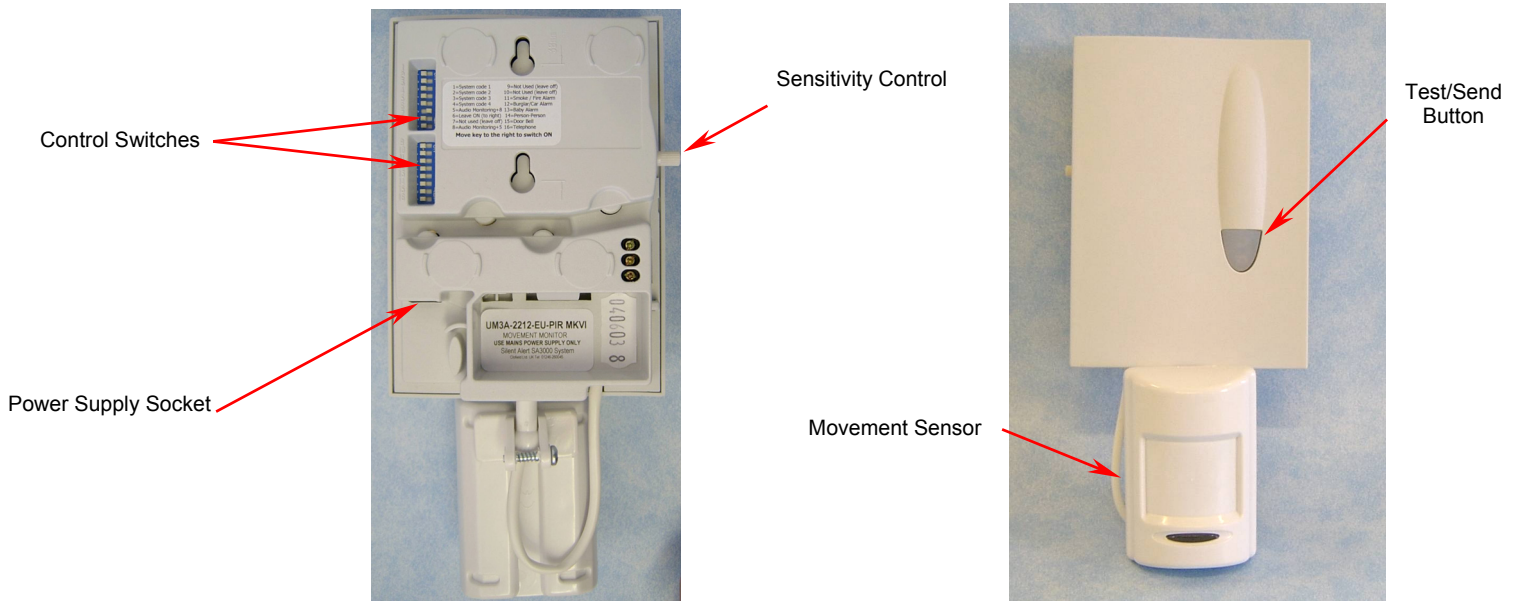

Getting Started

1. Ensure the Pager unit is fully charged and the Alarm Clock Charger or Trickle Charger is installed.
2. Plug the Power Supply into a 13amp mains socket and connect the lead into to the monitor socket.
3. The test button will flash orange until the PIR red light goes out. This is normal. (And may take up to 1 minute).
4. Move one of the control switches (11-16) to the right to determine which key lights on the Pager (See Table).
5. Angle the movement Sensory to the desired position and test the monitor in location before using the fixing screws.
6. Control switches 1-4 are for system-coding (On to the right) switch 6 acts as a system channel override.
7. Control switches 9 & 10 introduce a non-return delay, so if the unit is triggered on passing the sensor and a return pass is not made within the set time delays the unit will trigger. During the non-return time delay period the unit will display an orange light (armed and counting). The orange light will go out if the return pass is made before the time out.
Switch 9 = 5 Mins, Switch 10 = 10 Mins, Switch 9 & 10 = 15 Mins.
8. To activate the sound monitoring feature in addition to movement sensing move control switch 5 to the On position (to the right) and press the test button, adjust the sensitivity control to trigger at the desired sound level. It is possible to trigger the sound activation feature by handling the Monitor or whilst adjusting the sensitivity. There is also a 12 second delay after activation before the Monitor can be re triggered. Control switch 7 introduces a short delay before the audio triggers the unit. Switch 8 introduces a medium delay and 7 & 8 together a long delay. This is particularly useful when the unit is used as a Baby Alarm. An amber light shines when the audio monitor detects sounds. When a sound exceeds a preset delay, the amber light goes out and the green light shines to confirm that the signal has been sent.

Key on Pager	Control Switch
Telephone	16
Door Bell	15
Person-Person	14
Baby Alarm	13
Car / Burglar Alarm	12
Smoke / Fire Alarm	11

Monitor Key	Return Delay
9	5 Mins
10	10 Mins
9 + 10	15 Mins

9 100% Recycled Paper

New 2 Year Warranty

On All Silent Alert Products produced after 8th June 2009

NOT SUITABLE FOR CHILDREN UNDER 36 MONTHS BECAUSE OF SMALL PARTS. DO NOT IMMERSE THE UNIVERSAL MONITOR IN WATER OR ANY OTHER LIQUID. DO NOT SUBJECT THE UNIT TO EXCESSIVE MECHANICAL SHOCK.

The SA3000 System comprises a Pager Unit, either an Alarm Clock Charger or Trickle Charger, a Pillow Pad or Strobe Light & at least one Monitor. Clofield Ltd. Help Line 0800-387-397 Txt & Fax 01246-450789 e-mail deaf.info@silent-alert.co.uk