

UM3A-2212-EU-MIC MKX

Universal Monitor with External Microphone

Part of the SA3000 Paging System for deaf and deaf-blind people

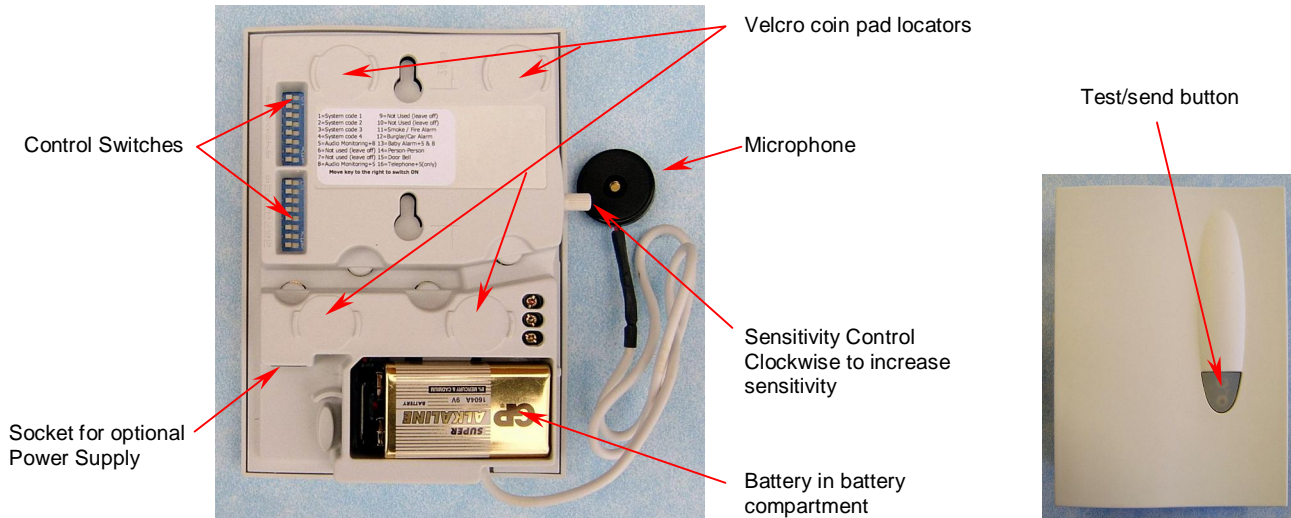

Getting Started

1. Ensure the pager unit is fully charged and the Alarm Clock Charger or Trickle Charger is installed.
2. Install a 9volt PP3 alkaline battery and or plug the power supply (sold separately) into a 13amp mains socket.
3. Move control switch (14 or 15) to the right to determine which key lights on the pager. Key 14 will light the Person to Person symbol, key 15 will light up the Doorbell symbol.
4. The monitor is activated by sound (using control switch 5). Pressing the Test/Send Button also activates the monitor. The external microphone can be placed behind a door entry phone or within its housing. The microphone can also be placed inside the battery compartment of a wireless door chime. It may be necessary to remove part of the battery cover to allow for the wire to exit the battery compartment.
5. Test the monitor in location before using either velcro pads or fixing screws.
6. An alkaline PP3 battery should last one year. Low battery signals will be sent to your pager when the battery needs changing. The test button also shines red instead of green when pressed to indicate that the battery is low.
7. Control switches 1-4 are for system coding (On to the right) switches 6 acts as a system channel override.
8. Control switch 7 introduces a short delay before the audio triggers the unit. Switch 8 introduces a medium delay and 7 & 8 together a long delay. This is particularly useful when the unit is used as a Baby Alarm. The amber light shines when the audio monitor picks up a sound, which changes to green when the audio delay has been exceeded.
9. We would not recommend that this device is used to monitor a normal telephone or the activation of a smoke alarm. Dedicated Telephone and combined smoke alarm units are available to perform these functions.

Sound	Control Switch	Set up	Other Information
Entry phone	5 & 14 ON	Place microphone inside or behind Entry Phone unit near to the buzzer.	Set sensitivity to the minimum (fully anticlockwise) & adjust so that it just triggers when the entry phone rings.

It may be necessary to readjust the sensitivity if other external noises trigger the Monitor.

NOT SUITABLE FOR CHILDREN UNDER 36 MONTHS BECAUSE OF SMALL PARTS. DO NOT IMMERSE THE UNIVERSAL MONITOR IN WATER OR ANY OTHER LIQUID. DO NOT SUBJECT THE UNIT TO EXCESSIVE MECHANICAL SHOCK.

New 2 Year Warranty
On All Silent Alert Products produced after 8th June 2009

9 100% Recycled Paper