

PG3A-2204-EU-YELL-MKIII Pager Unit **Fire Safe Compatible**

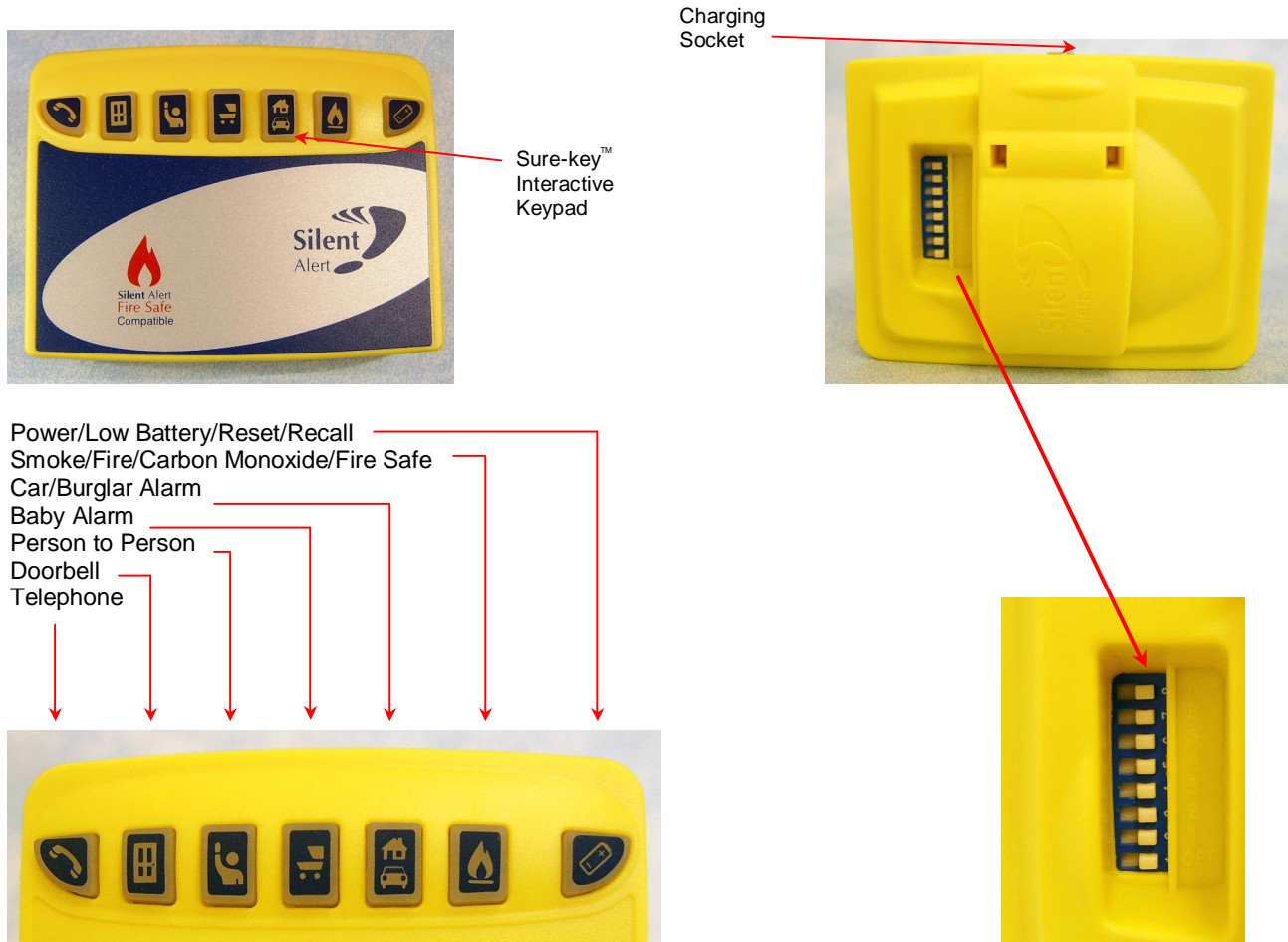

Part of the SA3000 Paging System for deaf and deaf-blind people



Getting Started

1. Move ON/OFF switch to the ON position (to the left, away from OFF). If there is sufficient charge in the battery, the pager will vibrate & the Sure-Key™ interactive keypad will light up four times.
2. Install either the alarm clock charger (Part No. CH3A-2205-IN) or the trickle charger (Part no. TR3A-2206-IN), insert the pager into the charging slot & charge for 24 hours.
3. Install the monitor units according to their instructions.
4. Remove the pager from the charger slot & operate each monitor in turn. The pager will respond by vibrating & lighting the relevant key.
5. To reset the pager & stop the vibration, press & hold the key that is lit. Once the correct key has been pressed the vibration will stop & the light will continue to flash for 10-15 seconds. Each signal will automatically cancel after 20-40 seconds except the fire key which if not cancelled will continue for approximately fifteen minutes.
6. An incoming signal can be cancelled by using the Battery/Reset/Recall button. In this case both the vibration & light are cancelled immediately. A fire signal however can only be cancelled using the fire key.
7. The pager incorporates a single use last event recall. If the Battery/Reset/ Recall button is held for 3 or more seconds the last signal received by the pager is repeated three times.
8. The battery key will flash once every 45 seconds to indicate that the pager is switched on.
9. The pager must be recharged each night & if not in use for more than 24 hours should be switched off. If the pager battery becomes low the pager will vibrate & the battery key will light up. This key will also light up & the pager will vibrate & alternate with one of the other keys when a battery in one of your monitors needs replacing.
10. The switches numbered 1-4 above the ON/OFF switch can be used to change the system code; the corresponding switches on the universal monitors must be On for the system to operate. These switches should only be changed if interference is received from another system close by. Switches 5, A & B are not used but must be left in the OFF position (to the right).

DO NOT IMMERSE THE PAGER UNIT IN WATER OR ANY OTHER LIQUID. DO NOT SUBJECT THE UNIT TO EXCESSIVE MECHANICAL SHOCK. ONLY RECHARGE THE PAGER WITH EITHER THE ALARM CLOCK CHARGER (PART NUMBER CH3A-2205-IN) OR TRICKLE CHARGER (PART NUMBER TR3A-2206-IN).

The SA3000 System comprises a Pager Unit, either an Alarm Clock Charger or Trickle Charger, a Pillow Pad and at least one Monitor. Clofield Ltd. Help Line Tel. 0800-387-397 Txt. 01246-572141 Fax. 01246-450789 e-mail deaf.info@silent-alert.co.uk



Fire Safe Compatible

New 2 Year Warranty

On All Silent Alert Products produced after 8th June 2009

9 100% Recycled Paper

The MKIII SA3000 Pager Unit is Fire Safe Compatible

All new Fire Safe compatible pagers marked with the Fire Safe Symbol supplied as part of the market leading Silent Alert SA3000 Home Paging System have a unique feature that allows the user access to fire alarms in all public buildings where the Fire Safe System is installed.

When entering a building where the Fire Safe logo is displayed, simply press the fire symbol on your pager keypad. The pager will vibrate and flash the fire symbol three times to confirm that fire safe cover has been activated, the fire key then flashes once every 7 seconds whilst ever the pager is in Fire Safe mode. If the fire alarm sounds whilst you are in the building you will be alerted automatically.

IMPORTANT NOTES

Within 4 minutes of leaving the building your pager will reset automatically and flash all the keys and vibrate 6 times, the fire key will then stop flashing. If this occurs whilst you are in a building where Fire Safe is fitted then this indicates that you are either out of range or the Fire Safe System is not functioning correctly. In either case you should press the fire key on your pager again. If the reset sequence repeats again report this to the person in charge of fire safety within that building.

Your pager will only operate with a Fire Safe System after you have activated Fire Safe mode by pressing the fire key on your pager. The fire key will flash once every 7 seconds whilst ever it is in Fire Safe mode.

Know Your Rights

Under the Disability Discrimination Act service providers are required by law to make the products services and premises accessible to people with disabilities. If you use a building regularly and it does not have a Fire Safe System installed, insist that the occupiers consider putting one in.