

MM4A-2212-EU MKI-LEAD Mini Monitor

FOR USE WITH UNDER CARPET PRESSURE PAD OR JELLY BEAN SWITCH

Part of the SA3000 Paging System for deaf and deaf-blind people

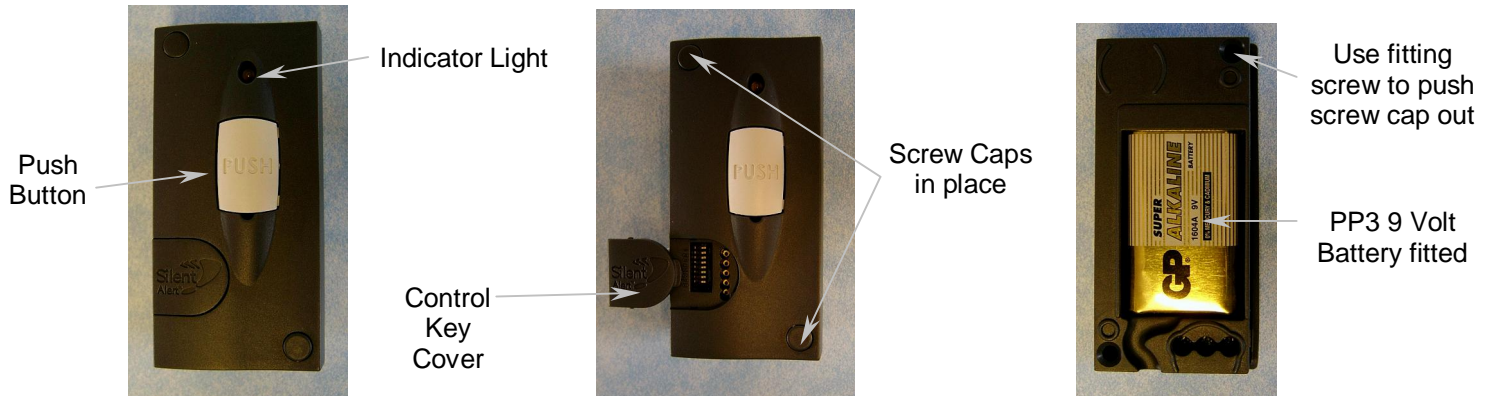

Getting Started

1. Install a 9 volt PP3 Alkaline or Lithium battery. **ONLY USE ALKALINE OR LITHIUM TYPE BATTERIES.**
2. When a battery is first fitted the indicator light flashes red then green several times, there is a brief pause and it then flashes green several times. The number of green flashes in this second sequence indicates the voltage in the battery. If the light flashes red then the battery is flat and should be replaced. To repeat the battery test, remove the battery then press the Push Button. When the battery is reconnected the battery will be retested automatically. Automatic low battery signals are sent to the Pager or SignWave when the battery runs low. In addition, the indicator light will shine red when the unit is activated or when the push button is pressed, if the battery is low.
3. Press the push button, the green light on the front on the monitor will light for a number of seconds, check that a signal is received by the Pager or SignWave and where applicable that the door chime activates.
4. Connect the Pressure Pad or the Jelly Bean Switch and check it activates the monitor (green transmit light illuminates) and the signal is received on the Pager or SignWave.

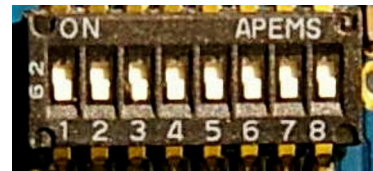
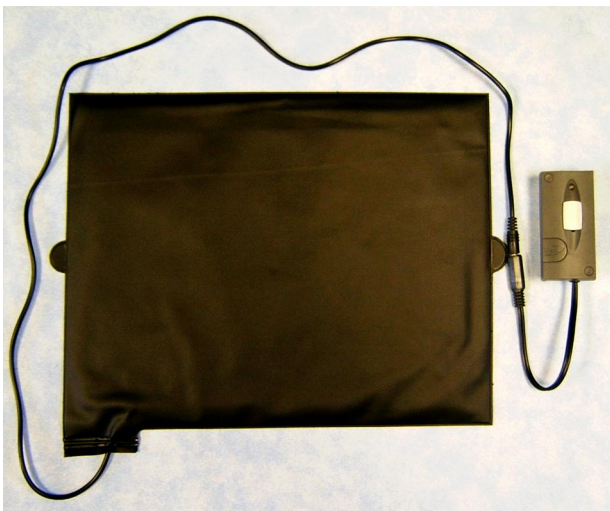

Control Switch settings

5. Control Keys 1-4 are for system coding. These must correspond to the settings on the Pager or SignWave.
6. Control Key 5 will cause the Person to Person symbol to light on the Pager & SignWave.
7. Control Key 6 will cause the Burglar Alarm Symbol to light on the Pager & SignWave.
8. Control Keys 5 & 6 together will cause the Fire Symbol to light on the Pager & SignWave.
9. Control Key 7 should be set to the on position to enable the plug in device to operate.

NOT SUITABLE FOR CHILDREN UNDER 36 MONTHS BECAUSE OF SMALL PARTS.

New 2 Year Warranty

On All Silent Alert Products produced after 8th June 2009

9 100% Recycled Paper